

DURA-ACE TRACK Rear Hub HB-7600-A-R

Wheels Mfg Part #:
Click on part # to order from wheelsmfg.com

Right Cone: N/A

Left Cone: N/A

Axle: AXLE-06

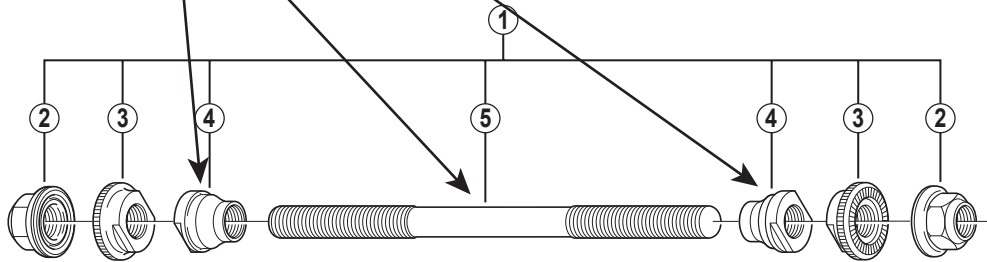

Wheels Mfg Part #:
Click on part # to order from wheelsmfg.com

Loose Bearings: BALL-14-25

Lockring: LOCKRINGTR

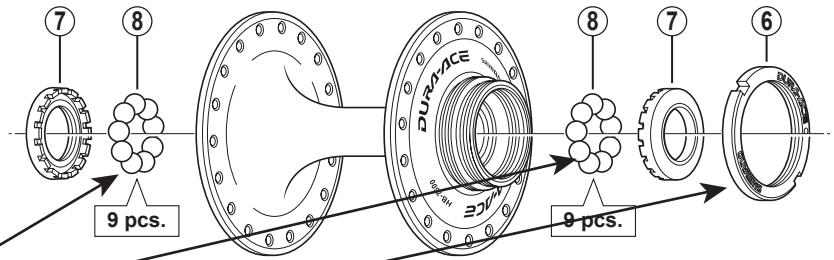

WHEELS MANUFACTURING INC.

• Over Lock Nut Dimension: 120 mm (4-23/32")

ITEM NO.	Wheels Mfg Part #	SHIMANO CODE NO.	DESCRIPTION	INTERCHANGEABILITY
1		Y23U98010	Complete Hub Axle 164 mm (6-15/32")	B A
2		Y24790020	Hub Nut (M10)	A
3		Y23U06000	Lock Nut	A
4		Y23U08000	Cone (M10 x 16.2 mm)	A
5	<u>AXLE-06</u>	Y23U05000	Hub Axle 164 mm (6-15/32")	A
6	<u>LOCKRINGTR</u>	Y27819000	Lock Ring	A A
7		Y27811000	Dust Cap	A
8	<u>BALL-14-25</u>	Y00091370	Stainless Ball (1/4") 18 pcs.	A A

A: Same parts.
B: Parts are usable, but differ in materials, appearance, finish, size, etc.
Absence of mark indicates non-interchangeability.

HB-7600-R
HB-7710-R

Sep.-2012-3464
© Shimano Inc. I

Specifications are subject to change without notice.

