

SHIMANO 105 Freehub FH-5600 8/9/10-Speed

Wheels Mfg Part #:

Click on part # to order from wheelsmfg.com

Right Cone: [CN-R060](#)

Left Cone: [CN-R002](#)

Axle: [AXLE-03](#)

Wheels Mfg Part #:

Click on part # to order from wheelsmfg.com

Axle Spacer: [AS-5](#)

Axle Spacer: [AS-4](#)

Loose Bearings: [BALL-14-25](#)

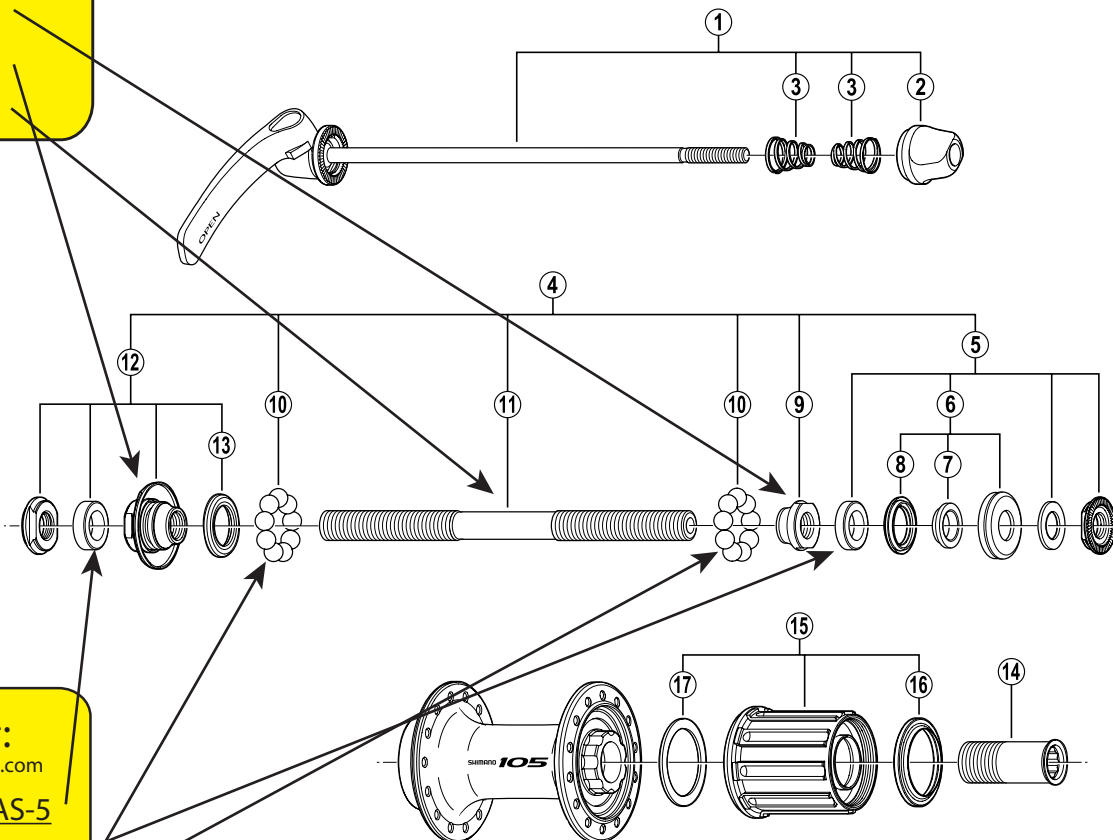

WHEELS MANUFACTURING INC.

ITEM NO.	Wheels Mfg Part #	SHIMANO CODE NO.	DESCRIPTION
1		Y-3CJ 98010	Complete Quick Release 163 mm (6-13/32")
2		Y-23W91100	Quick Release Nut
3		Y-231 11000	Volute Spring
4		Y-3CJ 98020	Complete Hub Axle 141 mm (5-9/16")
5		Y-3CJ 98030	Right Hand Lock Nut Unit
6		Y-3CJ 98040	Right Hand Dust Cap Unit
7	AS-4	Y-31V 03000	Right Hand Axle Spacer 3.7 mm
8		Y-214 06000	Right Hand Seal Ring
9	CN-R060	Y-3AE 03000	Right Hand Cone (M10 x 9 mm)
10	BALL-14-25	Y-000 91310	Steel Ball (1/4") 18 pcs.
11	AXLE-03	Y-301 05100	Hub Axle 141 mm (5-9/16")
12		Y-3CJ 98050	Left Hand Lock Nut Unit
13		Y-377 10000	Left Hand Seal Ring
14		Y-359 04000	Body Fixing Bolt
15		Y-3CJ 98070	Complete Freewheel Body
16		Y-3C7 03000	Sub Unit Rubber Seal
17		Y-375 04000	Freewheel Body Washer
	CN-R002		Left Hand Cone (M10 x 15mm)
	AS-5		Left Hand Axle Spacer, 5mm

Over Lock Nut Dimension: 130 mm (5-1/8")

0505-2458

Specifications are subject to change without notice.

SHIMANO