

CLARIS Freehub (8/9-Speed)

FH-2400 FH-2400-L

Wheels Mfg Part #:

Click on part # to order from wheelsmfg.com

Right Cone: [CN-R063](#)

Left Cone: [CN-R063](#)

Axle: [AXLE-03](#)

Wheels Mfg Part #:

Click on part # to order from wheelsmfg.com

Axle Spacer: [AS-5](#)

Loose Bearings: [BALL-14-25](#)

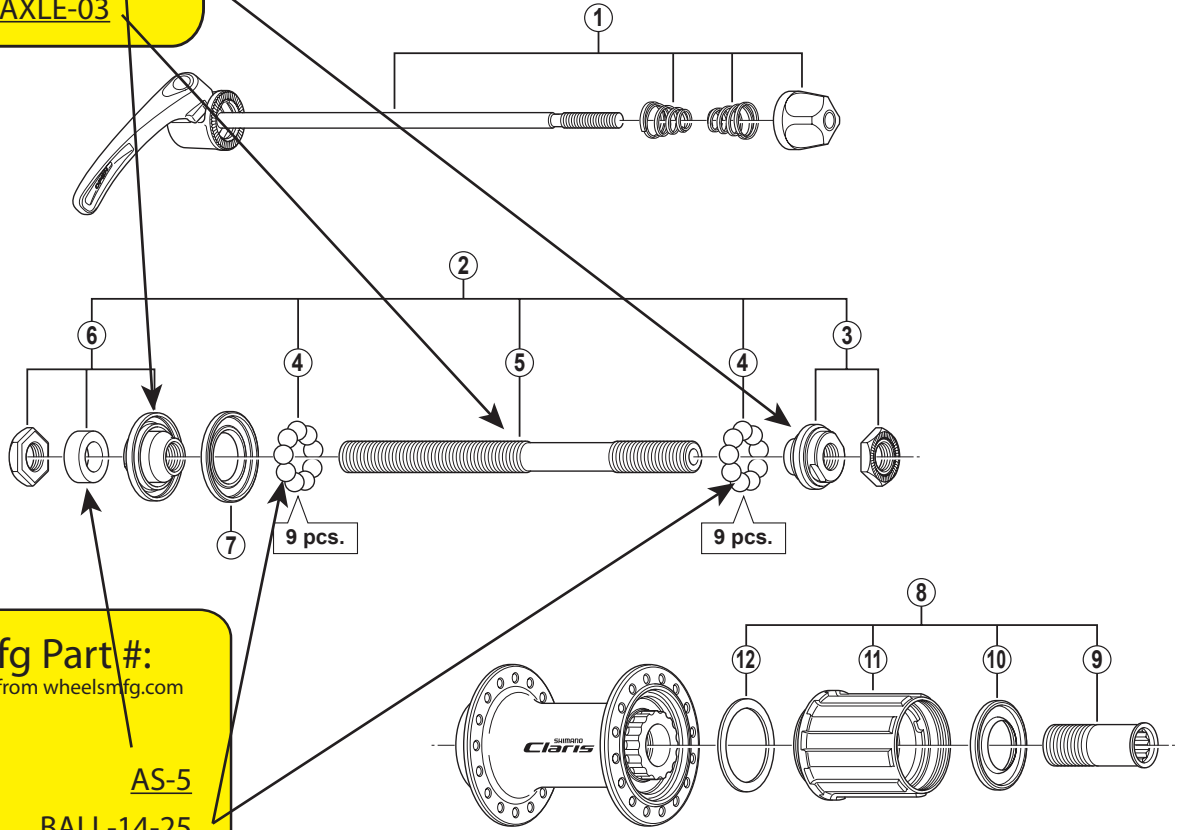

WHEELS MANUFACTURING INC.

• Over Lock Nut Dimension: 130 mm (5-1/8")

ITEM NO.	Wheels Mfg Part #	SHIMANO CODE NO.	DESCRIPTION	INTERCHANGEABILITY		
				FH-2200	FH-3500	FH-RM35
1		Y3E198010	Complete Quick Release 163 mm (6-13/32")	B	B	B
		Y3E198020	Complete Quick Release 168 mm (6-5/8")	B	B	B
2		Y3E098010	Complete Hub Axle 141 mm (5-9/16")	B	A	B
3		Y3E098020	Right Hand Lock Nut Unit	B	A	B
4	BALL-14-25	Y00091310	Steel Ball (1/4") 18 pcs.	A	A	A
5	AXLE-03	Y30K01100	Hub Axle M10 x 141 mm (5-9/16")	A	A	B
6		Y3E098030	Left Hand Lock Nut Unit	B	A	B
7		Y3CR09000	Left Hand Seal Ring		A	
8		Y3E198030	Complete Freewheel Body	B	B	B
9		Y3BL03000	Body Fixing Bolt	A	A	A
10		Y3CR08000	Right Hand Seal Ring		A	
11		Y3E198040	Freewheel Body Unit		B	A
12		Y3TD06000	Freewheel Body Washer		A	A
	AS-5		Left Hand Axle Spacer, 5mm			

A: Same parts.

B: Parts are usable, but differ in materials, appearance, finish, size, etc.

Absence of mark indicates non-interchangeability.

Feb.-2013-3487

© Shimano Inc. I

Specifications are subject to change without notice.

SHIMANO